

VT-PTCNMT

PTZ Corner Mount Adapter

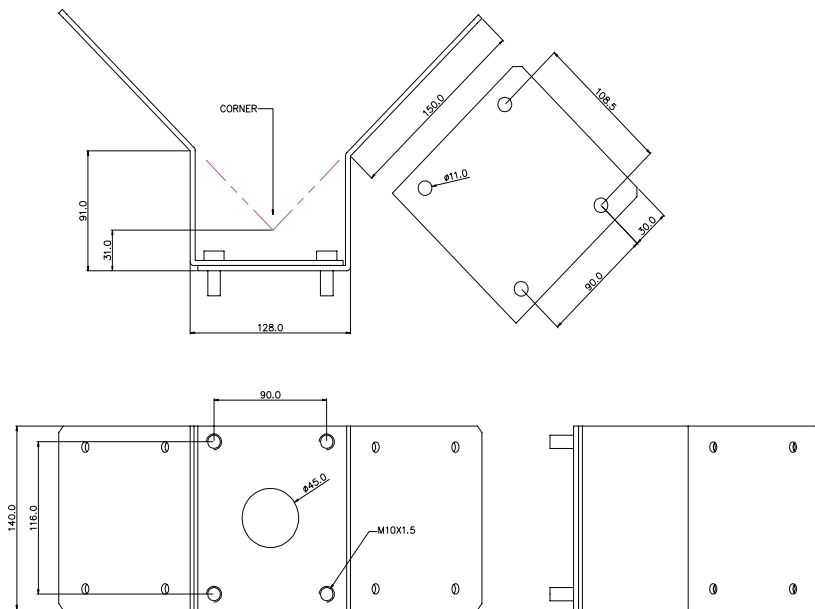

FEATURES

- Outdoor Use
- Aluminum and Steel Construction
- Light Gray Polyester Finish
- Use with VT-PTWMT: PTZ Wall Mount
- Maximum Load of 44lbs. (20Kg)
- Weight: 2.6lbs. (1.2Kg)